



## (7) Embraer ERJ-145LR Aircraft

Registrations	Serial Numbers	Year of Build
N11536	MSN 145520	2001
N11539	MSN 145536	2001
N13538	MSN 145527	2001
N14542	MSN 145547	2001
N16911	MSN 145446	2001
N21537	MSN 145523	2001
N26545	MSN 145558	2002

### SPECIFICATION SUMMARY

**Contact:**

**Bristol Associates, Inc.**

**Telephone: 202.682.4000**

**Fax: 202.682.1809**

**Email: [bristol@bristolassociates.com](mailto:bristol@bristolassociates.com)**

SPECIFICATIONS AND/OR DESCRIPTIONS ARE PROVIDED AS INTRODUCTORY INFORMATION ONLY AND DO NOT CONSTITUTE REPRESENTATIONS OR WARRANTIES OF BRISTOL OR BRISTOL'S CLIENTS. ACCORDINGLY, YOU SHOULD RELY ON YOUR OWN INSPECTION OF THE AIRCRAFT AND RECORDS. ANY PROPOSED TRANSACTION IS SUBJECT TO FINAL EXECUTION OF A CONTRACT ACCEPTABLE IN FORM AND SUBSTANCE TO BRISTOL, ITS CLIENTS AND THEIR COUNSEL

(7) Embraer ERJ-14LR Summary Spec  
Revised: May 14, 2021

LR AIRCRAFT BASICS	
Manufacturer:	Embraer
Type & Model:	ERJ-145LR
Manufacturer Date:	2001-2002
Country of Registration:	USA
Current Operator:	United Express
Number Available	7
Location	Kingman, AZ
	
LR OPERATING WEIGHTS	
Maximum Taxi Weight:	50,044 Lbs.
Maximum Take-Off Weight:	49,823 Lbs.
Maximum Zero Fuel Weight:	40,564 Lbs.
Maximum Landing Weight:	46,651 Lbs.
Operating Empty Weight:	26,707 Lbs.
LR FUEL DATA	
Fuel Capacity (Lbs):	11,998
INTERIOR	
Total Seats:	50 seats at 31" pitch
Seat Vendor:	C&D Zodiac
Galley Vendor:	C&D Zodiac
Avionics:	Honeywell Primus 1000 with EICAS Version 20.5

(7) Embraer ERJ-14LR Summary Spec  
Revised: May 14, 2021

### N11536 (YoB 2001)

AIRFRAME STATUS as of August 2020	
Total Airframe Hours:	42,812
Total Cycles:	33,427

AIRCRAFT MAINTENANCE PROGRAM as of August 2020	
C Check Due Date	05-Sep-2020

LANDING GEARS as of August 2020		
Nose Landing Gear		
Part Number:	1170C000-06	
Landing Gear Due Date	03-March-2022	
Main Landing Gear	Left Hand	Right Hand
Part Number:	2309-3002-515	2309-3002-516
Landing Gear Due Date	03-March-2022	03-March-2022

### N11539 (YoB 2001)

AIRFRAME STATUS as of August 2020	
Total Airframe Hours:	42,630
Total Cycles:	33,055

AIRCRAFT MAINTENANCE PROGRAM as of August 2020	
C Check Due Date	05-Sep-2020

LANDING GEARS as of August 2020		
Nose Landing Gear		
Part Number:	1170C000-06	
Landing Gear Due Date	26-April-2021	
Main Landing Gear	Left Hand	Right Hand
Part Number:	2309-3002-515	2309-3002-516
Landing Gear Due Date	26-April-2021	26-April-2021

(7) Embraer ERJ-14LR Summary Spec  
Revised: May 14, 2021



### N13538 (YoB 2001)

AIRFRAME STATUS as of August 2020	
Total Airframe Hours:	42,837
Total Cycles:	33,161

AIRCRAFT MAINTENANCE PROGRAM as of August 2020	
C Check Due Date	05-Sep-2020

LANDING GEARS as of August 2020		
Nose Landing Gear		
Part Number:	1170C000-06	
Landing Gear Due Date	28-May-2022	
Main Landing Gear	Left Hand	Right Hand
Part Number:	2309-3002-515	2309-3002-516
Landing Gear Due Date	28-May-2022	28-May-2022

### N14542 (YoB 2001)

AIRFRAME STATUS as of August 2020	
Total Airframe Hours:	42,750
Total Cycles:	33,803

AIRCRAFT MAINTENANCE PROGRAM as of August 2020	
C Check Due Date	05-Sep-2020

LANDING GEARS as of August 2020		
Nose Landing Gear		
Part Number:	1170C000-06	
Landing Gear Due Date	26-June-2021	
Main Landing Gear	Left Hand	Right Hand
Part Number:	2309-3002-515	2309-3002-516
Landing Gear Due Date	26-June-2021	26-June-2021

(7) Embraer ERJ-14LR Summary Spec  
Revised: May 14, 2021



### N16911 (YoB 2001)

AIRFRAME STATUS as of August 2020	
Total Airframe Hours:	42,700
Total Cycles:	32,981

AIRCRAFT MAINTENANCE PROGRAM as of August 2020	
C Check Due Date	02-Sep-2020

LANDING GEARS as of August 2020		
Nose Landing Gear		
Part Number:	1170C000-06	
Landing Gear Due Date	06-April-2022	
Main Landing Gear	Left Hand	Right Hand
Part Number:	2309-3002-515	2309-3002-516
Landing Gear Due Date	06-April-2022	06-April-2022

### N21537 (YoB 2001)

AIRFRAME STATUS as of August 2020	
Total Airframe Hours:	42,423
Total Cycles:	33,108

AIRCRAFT MAINTENANCE PROGRAM as of August 2020	
C Check Due Date	05-Sep-2020

LANDING GEARS as of August 2020		
Nose Landing Gear		
Part Number:	1170C000-06	
Landing Gear Due Date	02-December-2021	
Main Landing Gear	Left Hand	Right Hand
Part Number:	2309-3002-515	2309-3002-516
Landing Gear Due Date	02-December-2021	02-December-2021

(7) Embraer ERJ-14LR Summary Spec  
Revised: May 14, 2021



### N26545 (YoB 2002)

AIRFRAME STATUS as of August 2020	
Total Airframe Hours:	42,341
Total Cycles:	32,991

AIRCRAFT MAINTENANCE PROGRAM as of August 2020	
C Check Due Date	05-Sep-2020

LANDING GEARS as of August 2020		
Nose Landing Gear		
Part Number:	1170C000-06	
Landing Gear Due Date	27-June-2022	
Main Landing Gear	Left Hand	Right Hand
Part Number:	2309-3002-515	2309-3002-516
Landing Gear Due Date	27-June-2022	27-June-2022

---

(7) Embraer ERJ-14LR Summary Spec  
Revised: May 14, 2021

# Engine Data

\*Engine Disk sheets are available on request.

## Engine Data as of August 2020

MSN	145520	145536	145527	145547	145446	145523	145558
Reg #	N11536	N11539	N13538	N14542	N16911	N21537	N26545
<b>Engine 1</b>	<b>CAE310006</b>	<b>CAE311894</b>	<b>CAE311420</b>	<b>CAE312170</b>	<b>CAE311984</b>	<b>CAE310125</b>	<b>CAE311227</b>
TSLSV	2,090	2,918	5,043	4,091	2,091	1,756	5,578
CSLSV	1,672	2,445	4,084	3,330	2,218	1,472	4,711
Limiting LLP	3,957	6,124	2,297	9,553	4,114	4,778	6,518
<b>Engine 2</b>	<b>CAE312203</b>	<b>CAE310034</b>	<b>CAE310095</b>	<b>CAE311982</b>	<b>CAE312167</b>	<b>CAE311893</b>	<b>CAE312006</b>
TSLSV	1,226	4,810	3,296	4,894	2,987	3,231	5,575
CSLSV	1,053	4,014	2,691	4,139	2,451	2,669	4,573
Limiting LLP	6,734	2,445	3,861	3,976	7,061	4,808	4,092

(7) Embraer ERJ-14LR Summary Spec  
Revised: May 14, 2021



## Embraer ERJ145 Avionics Equipment

Nomenclature	Model	Quantity	Manufacturer	Part Number
Integrated Computer	IC-600	2	Honeywell	7017000-83430 (with AP) 7017000-83430 (w/o AP)
Data Acquisition Unit	DA-800	2	Honeywell	7013348-949
Attitude Heading Reference Unit	AH-900 or 800	2	Honeywell	HG2011AC03
Display Unit	DU-870	5	Honeywell	7014300-901
FMS Computer	NZ-2000	1 or 2	Honeywell	7018879-03014
GPS Computer	GNSSU	1 or 2	Honeywell	HG2021GD02 HG2021GD03
Air Data Computer	AZ-850	2	Honeywell	7014700-626
Radio Altimeter	RT-300	2	Honeywell	7001840-937
Integrated Com Unit	RCZ-851 RCZ-854	2	Honeywell	7510100-631 7510100-633
VHF #3	RCZ-833	1	Honeywell	7510700-833
Integrated Nav Unit	RNZ-851	2	Honeywell	7510100-631 7510100-633
ACARS/CMU	Mark III	1	Honeywell	7519200-920
Selcal	Jet Cal-2	1	Terra	2800-0012-102
Weather Radar	WU-660	1	Honeywell	7021450-601
EGPWS	Mark V	1	Honeywell	965-0976-003
TCAS	TCAS II TCAS2000	1	Honeywell	4066010-910 7517900-10003
DFDR	DFDR	1	Honeywell	980-4700-042
MFDAU	MFDAU	1	Teledyne	2243500-16-A
CVR	CVR	1	Honeywell	980-6022-001
Aural Warning Unit	AWU	1	Honeywell	80-0694-2-5
ELT	ELT	1	Artex	453-0150 455-5000

(7) Embraer ERJ-14LR Summary Spec  
Revised: May 14, 2021





## Avionics and Systems Notes

Nomenclature	Model	Quantity	Manufacturer	Part Number
Integrated Computer	IC-600	2	Honeywell	7017000-83432
Data Acquisition Unit	DA-800	2	Honeywell	7013348-949 (LR) 7013348-949 (XR)
Attitude Heading Reference Unit	AH-900 or 800	2	Honeywell	HG2011AC03
Display Unit	DU-870	5	Honeywell	7014300-901
FMS Computer	NZ-2000	2	Honeywell	7018879-03014
GPS WAAS	KGS-200	2	Honeywell	066-01201-0105
Air Data Computer	AZ-850	2	Honeywell	7014700-626
Radio Altimeter	RT-300	2	Honeywell	7001840-937
Integrated Communication Unit (ADS-B OUT)	RCZ-851 RCZ-854	2	Honeywell	7510733-616 7510733-623 7510733-666
VHF #3	RCZ-833	1	Honeywell	7510700-833
Integrated Nav Unit	RCZ-85	2	Honeywell	7510100-631 7510100-633
ACARS / CMU	Mark III	1	Honeywell	7519200-920
Selcal Decoder	Jet Cal-2	1	Terra	2800-0012-102
Weather Radar	WU-660	1	Honeywell	7021450-601
EGPWS	Mark V	1	Honeywell	965-0976-003-216-216
TCAS	TCAS II V7 TCAS II V7.1	1	Honeywell	7517900-10020 (V7) 4066010-913 (V7) 7517900-55020 (V7.1)
DFDR	DFDR	1	Honeywell	980-4700-042
MFDAU	MFDAU	1	Teledyne	2243500-16-A
CVR	CVR	1	Honeywell	980-6022-001
Aural Warning Unit	AWU	1	Honeywell	80-0694-2-5 80-0694-2-6
ELT	ELT	1	Artex	453-5000

(7) Embraer ERJ-14LR Summary Spec  
Revised: May 14, 2021



# LOPA

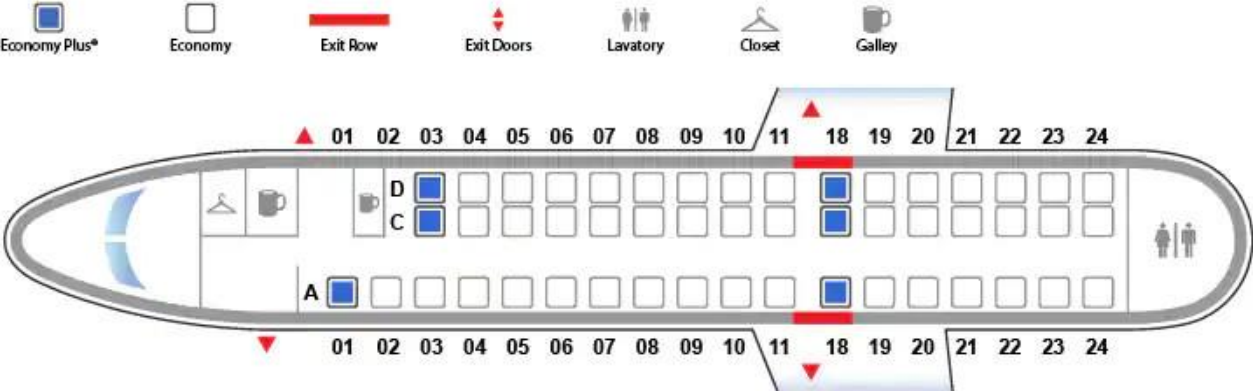

# Embraer ERJ145 LR COCKPIT LAYOUT

Glareshield



Dual Flight Management System (FMS)

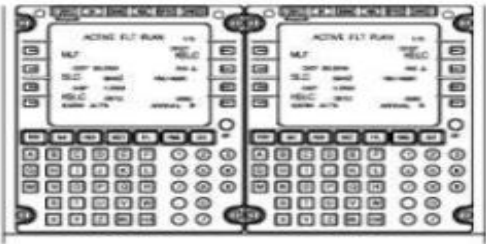

AIRCRAFT WITH DUAL FMS (HONEYWELL) INSTALLED  
ON THE CONTROL PEDESTAL FORWARD PANEL

Forward Center Pedestal

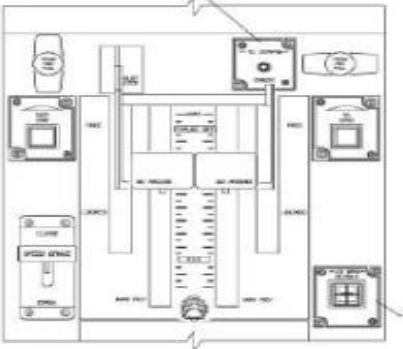

(7) Embraer ERJ-14LR Summary Spec  
Revised: May 14, 2021

# Embraer ERJ145 LR

## COCKPIT LAYOUT (continued)

Aft Center Pedestal

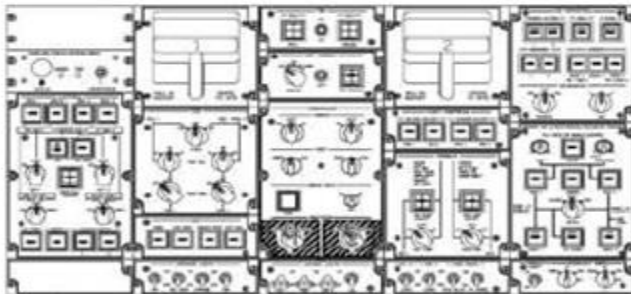

Overhead Instrument Panel

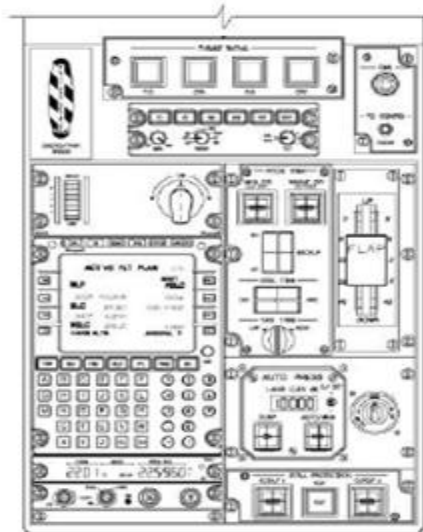

## Embraer ERJ145 LR Galley Configuration

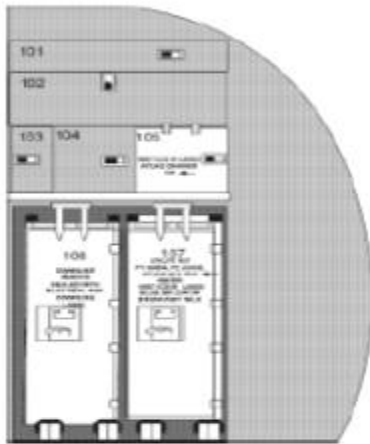

### GALLEY 1

S#	PART #	DESCRIPTION:
1	BULK	EMERGENCY EQUIPMENT
2	BULK	EMERGENCY EQUIPMENT
3	BULK	EMERGENCY EQUIPMENT
4	BULK	EMERGENCY EQUIPMENT
5	MS088	ATLAS DRAWER WITH WET ICE 10# - 17 lbs., weighed 5/16/05
6	8-9512	SNACK CART W/ DOWNLINE SNACKS
7	8-9512	RESTOCK CART - 114.1 lbs. Weighed 5/16/05

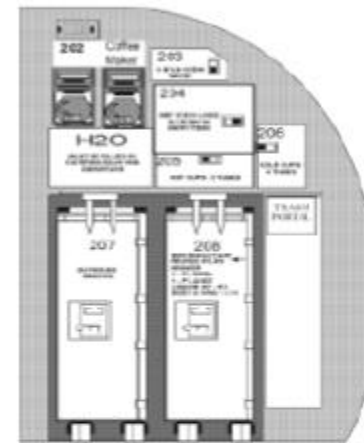

### GALLEY 2

POS#	PART #	DESCRIPTION:
202A	81341	COFFEE BREW POT
202B	81341	COFFEE BREW POT
203	BULK	3 EA. CREW BOTTLES WATER- 10.3 lbs. Weighed 5/16/05
204	MS088	WET ICE 10# IN LINED BLUE BIN 8-9692 / LINER 8-9310 W/ COE DAIRY ITEMS- 19.7 lbs weighed 5/16/05
205	BULK	HOT CUPS - 3 TUBES .5 lb. Weighed 5/16/05
206	BULK	COLD CUPS - 4 TUBES 1.6 lbs. Weighed 5/16/05
207	8-9512	SNACK CART - W/ OUTBOUND SNACKS
208	8-9512	BEVERAGE CART - H.10X 109.4 weighed 5/16/05
209	BULK	BIN, TRASH W/LINER 8-9181

(7) Embraer ERJ-14LR Summary Spec  
Revised: May 14, 2021